

AGENDA ITEM NO.

TRAFFORD COUNCIL

THE LICENSING SUB COMMITTEE – 8TH JULY 2015

REPORT OF THE HEAD OF PUBLIC PROTECTION

REPORT REF. NO.

**APPLICATION FOR THE GRANT OF A PREMISES LICENCE –
URMSTON MEN'S CLUB & INSTITUTE, 82 HIGHER ROAD, URMSTON**

PURPOSE

To invite Members to consider a representation from the Pollution Section recommending the attachment of conditions to the licence that has been agreed by the applicant.

OPTIONS

The Sub-Committee to take such steps as they consider necessary for the promotion of the Licensing Objectives in accordance with the provisions of subsection 18 (4) of the Licensing Act 2003.

It be **RESOLVED** that the application for a Premises Licence be determined.

**Iain Veitch
Head of Public Protection**

Further Information From:

Name: Steve Bate
Senior Licensing Officer
Extension: 4144

Proper Officer for the purposes of L.G.A 1972,S.100D
(background papers): Head of Public Protection

Appendices:

Appendix A – Application and Operating Schedule (including layout of premises)

Appendix B – Conditions agreed with the applicant and confirmation that a full hearing is not necessary.

1. Application for the Grant of a Premises Licence.

- 1.1 On the 13th May, 2015 the Licensing Section received an application from Urmston Men's Club & Institute, for the grant of a premises licence for Urmston Men's Club & Institute, 82 High Road, Urmston. (**Appendix A**).
- 1.2 The application requested the granting of a premises licence to provide sale of alcohol (on & off) the premises, late night refreshment and regulated entertainment.
- 1.3 The hours requested for the licensable activities on the original application are as follows:

Sale of Alcohol (on & off premises):
Monday to Sunday – 10:00 to 00:00

Late Night Refreshment (Indoors):
Monday to Sunday – 23:00 to 00:00

Provision of Regulated Entertainment (plays; films; indoor sports; boxing or wrestling, live music; recorded music; and performance of dance):

Monday to Sunday – 10:00 to 00:00

- 1.4 The applicant has complied with all requirements under the application process including advertising the application in a newspaper, advertising by way of public notice at the premises and submitting a copy of the complete application to all Responsible Authorities. The application is deemed to be correctly submitted.

2. Representations

- 2.1 During the consultation period, a representation was received from the Council's Pollution Section (**Appendix B**).
- 2.2 The recommended conditions have been agreed by the applicant and will form part of the proposed conditions to be attached to the premises licence (**Appendix B**).

3. Options

The Members are invited to consider the representation and the agreement given by the applicant and either:

- Agree that a hearing is not necessary and determine to grant the licence subject to the conditions being attached; or
 - Agree that a hearing is necessary with all the parties present.

APPENDIX A

Application and Operating Schedule

AW 500136745 £19000 LDD: 10/6 LA0208/15

Trafford Council
Application for a premises licence to be granted
under the Licensing Act 2003

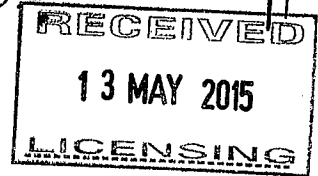

PLEASE READ THE FOLLOWING INSTRUCTIONS FIRST

Before completing this form please read the guidance notes at the end of the form. If you are completing this form by hand please write legibly in block capitals. In all cases ensure that your answers are inside the boxes and written in black ink. Use additional sheets if necessary.

You may wish to keep a copy of the completed form for your records.

ULA xxx 8211/1
TC2 01889

I/We **Urmston Men's Club & Institute**

(Insert name(s) of applicant)

apply for a premises licence under section 17 of the Licensing Act 2003 for the premises described in Part 1 below (the premises) and I/we are making this application to you as the relevant licensing authority in accordance with section 12 of the Licensing Act 2003

PL056685

Part 1 - Premises Details,

Postal address of premises or, if none, ordnance survey map reference or description

82 Higher Road

Post town

Urmston

Postcode

M41 9AP

Telephone number at premises (if any)

0161 748 2800

Non-domestic rateable value of premises

£20,000

Part 2 - Applicant Details

Please state whether you are applying for a premises licence as

Please tick as appropriate

- a) an individual or individuals * please complete section (A)
- b) a person other than an individual *
 - i. as a limited company please complete section (B)
 - ii. as a partnership please complete section (B)
 - iii. as an unincorporated association or please complete section (B)
 - iv. other (for example a statutory corporation) please complete section (B)
- c) a recognised club please complete section (B)
- d) a charity please complete section (B)
- e) the proprietor of an educational establishment please complete section (B)
- f) a health service body please complete section (B)

- g) a person who is registered under Part 2 of the Care Standards Act 2000 (c14) in respect of an independent hospital in Wales please complete section (B)
- ga) a person who is registered under Chapter 2 of Part 1 of the Health and Social Care Act 2008 (within the meaning of that Part) in an independent hospital in England please complete section (B)
- h) the chief officer of police of a police force in England and Wales please complete section (B)

* If you are applying as a person described in (a) or (b) please confirm:

Please tick yes

- I am carrying on or proposing to carry on a business which involves the use of the premises for licensable activities; or
- I am making the application pursuant to a
 - statutory function or
 - a function discharged by virtue of Her Majesty's prerogative

(A) INDIVIDUAL APPLICANTS (fill in as applicable)

Mr <input type="checkbox"/>	Mrs <input type="checkbox"/>	Miss <input type="checkbox"/>	Ms <input type="checkbox"/>	Other Title (for example, Rev)	
Surname			First names		
I am 18 years old or over			Please tick yes		
Current postal address if different from premises address					
Post town				Postcode	
Daytime contact telephone number					
E-mail address (optional)					

SECOND INDIVIDUAL APPLICANT (if applicable)

Mr <input type="checkbox"/>	Mrs <input type="checkbox"/>	Miss <input type="checkbox"/>	Ms <input type="checkbox"/>	Other Title (for example, Rev)	
Surname			First names		
I am 18 years old or over					<input type="checkbox"/> Please tick yes
Current postal address if different from premises address					
Post town				Postcode	
Daytime contact telephone number					
E-mail address (optional)					

(B) OTHER APPLICANTS

Please provide name and registered address of applicant in full. Where appropriate please give any registered number. In the case of a partnership or other joint venture (other than a body corporate), please give the name and address of each party concerned.

Name Urmston Men's Club & Institute
Address 82 Higher Road Urmston M41 9AP
Registered number (where applicable) 32312R
Description of applicant (for example, partnership, company, unincorporated association etc.) Mutual Society
Telephone number (if any) Club - 0161 748 2800 Office 0161 748 9022
E-mail address (optional) info@urmstonmens.org

Part 3 Operating Schedule

When do you want the premises licence to start?

DD MM YYYY

1	0	0	6	2	0	1	5
---	---	---	---	---	---	---	---

If you wish the licence to be valid only for a limited period, when do you want it to end?

DD MM YYYY

1	1	1	1	1	1	1	1
---	---	---	---	---	---	---	---

Please give a general description of the premises (please read guidance note 1)

Private members club situated on a main road in a commercial/residential area on the outskirts of the town.

If 5,000 or more people are expected to attend the premises at any one time, please state the number expected to attend.

--

What licensable activities do you intend to carry on from the premises?

(Please see sections 1 and 14 of the Licensing Act 2003 and Schedules 1 and 2 to the Licensing Act 2003)

Provision of regulated entertainment

Please tick any that apply

- a) films (if ticking yes, fill in box B) X
- b) indoor sporting events (if ticking yes, fill in box C) X
- c) boxing or wrestling entertainment (if ticking yes, fill in box D) X
- d) live music (if ticking yes, fill in box E) X
- e) recorded music (if ticking yes, fill in box F) X
- f) performances of dance (if ticking yes, fill in box G) X
- g) anything of a similar description to that falling within (e), (f) or (g) (if ticking yes, fill in box H) X

Provision of late night refreshment (if ticking yes, fill in box I) X

Supply of alcohol (if ticking yes, fill in box J) X

In all cases complete boxes K, L and M

A

Plays Standard days and timings (please read guidance note 6)			Will the performance of a play take place indoors or outdoors or both – please tick (please read guidance note 2)	Indoors	X
Day	Start	Finish		Outdoors	<input type="checkbox"/>
				Both	<input type="checkbox"/>
Mon	10.00	00.00		Please give further details here (please read guidance note 3) For example: Local Amateur Dramatic Society staging plays for public viewing	
Tue	10.00	00.00			
Wed	10.00	00.00	State any seasonal variations for performing plays (please read guidance note 4)		
Thur	10.00	00.00			
Fri	10.00	00.00	Non standard timings. Where you intend to use the premises for the performance of plays at different times to those listed in the column on the left, please list (please read guidance note 5)		
Sat	10.00	00.00			
Sun	10.00	00.00			

B

Films Standard days and timings (please read guidance note 6)			Will the exhibition of films take place indoors or outdoors or both – please tick (please read guidance note 2)	Indoors	X
Day	Start	Finish		Outdoors	<input type="checkbox"/>
				Both	<input type="checkbox"/>
Mon	10.00	00.00		Please give further details here (please read guidance note 3) Sporting films or films of local interest	
Tue	10.00	00.00			
Wed	10.00	00.00	State any seasonal variations for the exhibition of films (please read guidance note 4)		
Thur	10.00	00.00			
Fri	10.00	00.00	Non standard timings. Where you intend to use the premises for the exhibition of films at different times to those listed in the column on the left, please list (please read guidance note 5)		
Sat	10.00	00.00			
Sun	10.00	00.00			

C

Indoor sporting events Standard days and timings (please read guidance note 6)			Please give further details (please read guidance note 3) Tournament matches	
Day	Start	Finish		
Mon	10.00		State any seasonal variations for indoor sporting events (please read guidance note 4)	
		00.00		
Tue	10.00			
		00.00		
Wed	10.00			Non standard timings. Where you intend to use the premises for indoor sporting events at different times to those listed in the column on the left, please list (please read guidance note 5)
		00.00		
Thur	10.00			
		00.00		
Fri	10.00			
		00.00		
Sat	10.00			
		00.00		
Sun	10.00			
		00.00		

7

Boxing or wrestling entertainments Standard days and timings (please read guidance note 6)			Will the boxing or wrestling entertainment take place indoors or outdoors or both – please tick (please read guidance note 2)			
Day	Start	Finish	Indoors	Outdoors		
Mon	10.00		<input checked="" type="checkbox"/>	<input type="checkbox"/>		
		00.00		<input type="checkbox"/>		
Tue	10.00			<input type="checkbox"/>		
		00.00		<input type="checkbox"/>		
Wed	10.00		State any seasonal variations for boxing or wrestling entertainment (please read guidance note 4)			
		00.00				
Thur	10.00					
		00.00				
Fri	10.00				Non standard timings. Where you intend to use the premises for boxing or wrestling entertainment at different times to those listed in the column on the left, please list (please read guidance note 5)	
		00.00				
Sat	10.00					
		00.00				
Sun	10.00					
		00.00				

E

Live music Standard days and timings (please read guidance note 6)			Will the performance of live music take place indoors or outdoors or both – please tick (please read guidance note 2)	Indoors	X
				Outdoors	<input type="checkbox"/>
				Both	<input type="checkbox"/>
Day	Start	Finish	<u>Please give further details here</u> (please read guidance note 3)		
Mon	10.00	00.00			
Tue	10.00	00.00			
Wed	10.00	00.00	<u>State any seasonal variations for the performance of live music</u> (please read guidance note 4)		
Thur	10.00	00.00			
Fri	10.00	00.00	<u>Non standard timings. Where you intend to use the premises for the performance of live music at different times to those listed in the column on the left, please list</u> (please read guidance note 5)		
Sat	10.00	00.00			
Sun	10.00	00.00			

F

Recorded music Standard days and timings (please read guidance note 6)			Will the playing of recorded music take place indoors or outdoors or both – please tick (please read guidance note 2)	Indoors	X
				Outdoors	<input type="checkbox"/>
				Both	<input type="checkbox"/>
Day	Start	Finish	<u>Please give further details here</u> (please read guidance note 3)		
Mon	10.00	00.00			
Tue	10.00	00.00			
Wed	10.00	00.00	<u>State any seasonal variations for the playing of recorded music</u> (please read guidance note 4)		
Thur	10.00	00.00			
Fri	10.00	00.00	<u>Non standard timings. Where you intend to use the premises for the playing of recorded music at different times to those listed in the column on the left, please list</u> (please read guidance note 5)		
Sat	10.00	00.00	Christmas Eve until 01.00 and New Years Eve until 02.00		
Sun	10.00	00.00			

G

Performances of dance Standard days and timings (please read guidance note 6)			<u>Will the performance of dance take place indoors or outdoors or both – please tick</u> (please read guidance note 2)	Indoors	X
Day	Start	Finish		Outdoors	<input type="checkbox"/>
				Both	<input type="checkbox"/>
Mon	10.00			Please give further details here (please read guidance note 3)	
		00.00			
Tue	10.00				
		00.00			
Wed	10.00			State any seasonal variations for the performance of dance (please read guidance note 4)	
		00.00			
Thur	10.00				
		00.00			
Fri	10.00			Non standard timings. Where you intend to use the premises for the performance of dance at different times to those listed in the column on the left, please list (please read guidance note 5)	
		00.00			
Sat	10.00				
		00.00			
Sun	10.00				
		00.00			

Anything of a similar description to that falling within (e), (f) or (g) Standard days and timings (please read guidance note 6)			Please give a description of the type of entertainment you will be providing		
Day	Start	Finish	<u>Will this entertainment take place indoors or outdoors or both – please tick</u> (please read guidance note 2)	Indoors	X
Mon	10.00			Outdoors	<input type="checkbox"/>
				Both	<input type="checkbox"/>
Tue	10.00			Please give further details here (please read guidance note 3)	
		00.00			
Wed	10.00				
		00.00			
Thur	10.00			State any seasonal variations for entertainment of a similar description to that falling within (e), (f) or (g) (please read guidance note 4)	
		00.00			
Fri	10.00				
		00.00			
Sat	10.00			Non standard timings. Where you intend to use the premises for the entertainment of a similar description to that falling within (e), (f) or (g) at different times to those listed in the column on the left, please list (please read guidance note 5)	
		00.00			
Sun	10.00				
		00.00			

I

Late night refreshment Standard days and timings (please read guidance note 6)			Will the provision of late night refreshment take place indoors or outdoors or both – please tick (please read guidance note 2)	Indoors	X
				Outdoors	<input type="checkbox"/>
				Both	<input type="checkbox"/>
Day	Start	Finish			
Mon			<u>Please give further details here</u> (please read guidance note 3)		
	23.00	00.00			
Tue					
	23.00	00.00			
Wed			<u>State any seasonal variations for the provision of late night refreshment</u> (please read guidance note 4)		
	23.00	00.00			
Thur					
	23.00	00.00			
Fri			<u>Non standard timings. Where you intend to use the premises for the provision of late night refreshment at different times, to those listed in the column on the left, please list</u> (please read guidance note 5) Christmas Eve until 01.00 and New Years Eve until 02.00		
	23.00	00.00			
Sat					
	23.00	00.00			
Sun					
	23.00	00.00			

J

Supply of alcohol Standard days and timings (please read guidance note 6)			Will the supply of alcohol be for consumption – please tick (please read guidance note 7)	On the premises	X
				Off the premises	X
				Both	X
Day	Start	Finish			
Mon	10.00		<u>State any seasonal variations for the supply of alcohol</u> (please read guidance note 4)		
		00.00			
Tue	10.00				
		00.00			
Wed	10.00				
		00.00			
Thur	10.00		<u>Non standard timings. Where you intend to use the premises for the supply of alcohol at different times to those listed in the column on the left, please list</u> (please read guidance note 5) Christmas Eve until 01.00 and New Years Eve until 02.00		
		00.00			
Fri	10.00				
		00.00			
Sat	10.00				
		00.00			
Sun	10.00				
		00.00			

State the name and details of the individual whom you wish to specify on the licence as designated premises supervisor:

Name Miss Lisa Blissett	
Address 4 Estonfield Drive Urmston Manchester	
Postcode	M41 9RR
Personal licence number (if known) To follow	
Issuing licensing authority (if known) Trafford Council	

K

<p>Please highlight any adult entertainment or services, activities, other entertainment or matters ancillary to the use of the premises that may give rise to concern in respect of children (please read guidance note 8). All gaming machines for public use will be sited in view of the bar.</p>

L

<p>Hours premises are open to the public</p>			<p><u>State any seasonal variations</u> (please read guidance note 4)</p> <p>Non standard timings. Where you intend the premises to be open to the public at different times from those listed in the column on the left, please list (please read guidance note 5)</p> <p>Christmas Eve until 01.30 and New Years Eve until 02.30</p>
<p>Standard days and timings (please read guidance note 6)</p>			
Day	Start	Finish	
Mon	10.00		
		00.30	
Tue	10.00		
		00.30	
Wed	10.00		
		00.30	
Thur	10.00		
		00.30	
Fri	10.00		
		00.30	
Sat	10.00		
		00.30	
Sun	10.00		
		00.30	

M Describe the steps you intend to take to promote the four licensing objectives:

a) General – all four licensing objectives (b, c, d and e) (please read guidance note 9)

All licensing activities permitted by this Premises Licence will only be carried out on pre-booked functions. Customers entering and exiting the front of the premises will be monitored by staff.

CCTV has been installed at the premises to cover customer areas. The equipment will be maintained to the standard of the Gtr. Manchester Police Policy. All images to be retained for a minimum of 31 days. The premises are alarmed when closed.

b) The prevention of crime and disorder

When the DPS is not on duty a contact telephone number will be available at all times.

Records of incidents will be recorded in an **Incident log** and retained on the premises for 12 months. The premises will operate and record all incidents of criminal activities, anti-social behaviour and injuries to persons using the following Compliance log books **Customer Refusal, Authorisation of Alcohol, ID Signature** to assist the police and authorities in carrying out their investigations. All log books are fit for purpose and will be retained on the premises for 12 months.

c) Public safety

The maximum capacity of the Concert Room shall not exceed 250 persons. No further risk has been assessed under the Licensing Act 2003

d) The prevention of public nuisance

A risk assessment shall be conducted when live or recorded music is being played, to assess the noise levels at the nearest residential/noise sensitive premises at the rear of the premises. Remedial action to be taken if necessary to reduce noise levels and to ensure residential premises will not be adversely affected. All assessments to be recorded in a **Noise assessment** log book.

e) The protection of children from harm

All children under the age of 18 will be accompanied by a responsible adult. A "Challenge 21" policy shall be operated at the premises at all times.

The only forms of ID that shall be accepted (at the discretion of the Management) as proof of age are a valid passport, a valid photographic driving licence, a PASS approved proof of age card, HM Services Warrant Card or other reliable photo I.D. that is approved for acceptance by the Police or other Authorised Officers. Publicity materials notifying customers of the operation of the "Challenge 21" scheme shall be displayed at the premises. The Designated Premises Supervisor or Premises Licence Holder shall operate and maintain an up-to-date Register of Refusals of Sale of Alcohol, indicating the date, time and reason for refusal which shall be made available for inspection by Trading Standards, Licensing Authority Officers and the Police. Alternatively an electronic point of sale refusals log shall be kept. A documented training programme shall be introduced for all staff in a position to sell, serve or deliver alcohol. The programme shall be made available for inspection at the request of Trading Standards, Licensing Authority Officers and Police. The DPS or Premises Licence Holder shall conduct six monthly reviews with all members of staff authorised to sell alcohol in order to reinforce the training and to promote best practice. A written record shall be kept of the content of such reviews.

Checklist:

Please tick to indicate agreement

- I have made or enclosed payment of the fee. X
- I have enclosed the plan of the premises. X
- I have sent copies of this application and the plan to responsible authorities and others where applicable. X
- I have enclosed the consent form completed by the individual I wish to be designated premises supervisor, if applicable. X
- I understand that I must now advertise my application. X
- I understand that if I do not comply with the above requirements my application will be rejected. X

IT IS AN OFFENCE, LIABLE ON SUMMARY CONVICTION TO A FINE NOT EXCEEDING LEVEL 5 ON THE STANDARD SCALE, UNDER SECTION 158 OF THE LICENSING ACT 2003, TO MAKE A FALSE STATEMENT IN OR IN CONNECTION WITH THIS APPLICATION.

Part 4 – Signatures (please read guidance note 10)

Signature of applicant or applicant’s solicitor or other duly authorised agent (see guidance note 11). **If signing on behalf of the applicant, please state in what capacity.**

Signature	<i>June Clarke - JMC</i>
Date	Wednesday 12 th May 2015
Capacity	Agent on behalf of the applicant

For joint applications, signature of 2nd applicant or 2nd applicant’s solicitor or other authorised agent (please read guidance note 12). **If signing on behalf of the applicant, please state in what capacity.**

Signature	
Date	
Capacity	

Contact name (where not previously given) and postal address for correspondence associated with this application (please read guidance note 13)

**June Clarke
Licensing Consultant
Warrington Business Park
Long Lane**

Post town	Warrington	Postcode	WA2 8TX
Telephone number (if any)	01925 419684 M: 07834 529 712		

If you would prefer us to correspond with you by e-mail, your e-mail address (optional)
licensinghouse@me.com

Urmston Mens Club & Institute, Higher Road, Urmston.

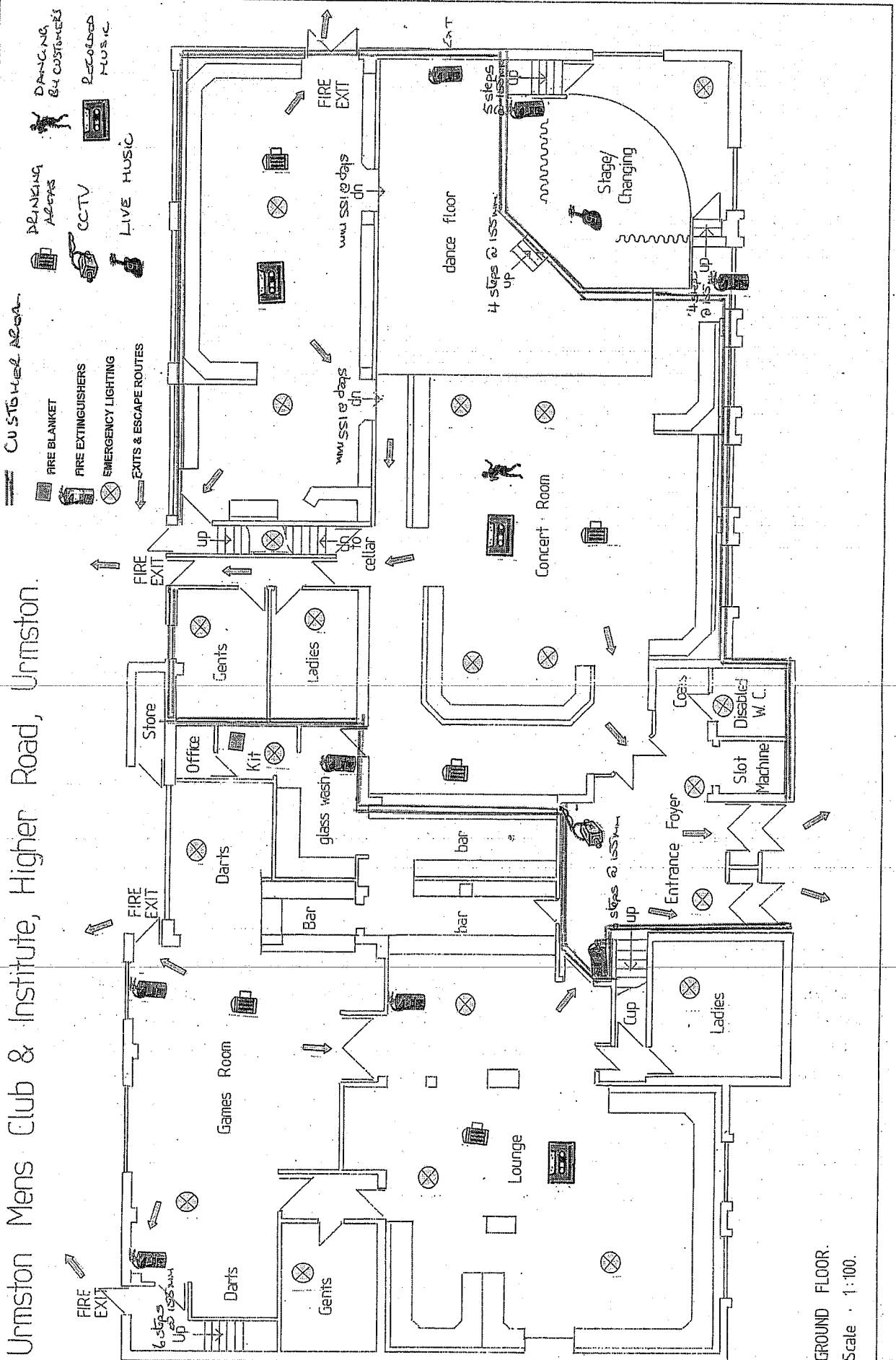

GROUND FLOOR.
Scale 1:100.

APPENDIX B

Conditions agreed with the Applicant and confirmation that a full hearing is not necessary

Please insert your full correspondence address below:

JMC Licensing Consultants
Warrington Business Park
Long Lane
Warrington
Cheshire
WA2 8TX

Licensing Manager
Licensing Section
Trafford Council
Trafford Town Hall
Talbot Road
Stretford
Manchester
M32 0YJ

Dear Sir/Madam

APPLICATION : PL056685
(insert number)

PREMISES : Urmston Men's Club & Institute,
82 Higher Road, Urmston, Manchester, M41 9AP
(insert name & address of premises)

I, June Clarke, Agent (on behalf of Urmston Men's Club & Institute) wish to confirm that we agree to include on the operating schedule, the conditions as agreed with Mr Richard Pollitt, Scientific Officer, Trafford Council, Pollution, Housing and Licensing and detailed overleaf.
(insert responsible authority/authorities)

I confirm that under the circumstances, I, on behalf of my client, do not consider a full committee hearing to be necessary.

Yours faithfully

Signature :

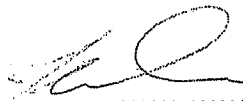
 JMC LICENSING CONSULTANT.

Name :

JUNE CLARKE (AGENT)

Date :

Wednesday 10th June 2015.

**AGREED ADDITIONAL CONDITIONS
TO BE INCLUDED ON LICENCE**

PPN3

"Noise from music and associated sources(including DJ's and amplified voices) must not be audible to such an extent that it constitutes a nuisance at any noise sensitive properties".

PPN4

All external doors and windows shall be kept closed when regulated entertainment is being provided except in the event of an emergency.

PPN6

There shall be placed at all exits from the premises in a place where they can be seen and easily read by the public, (or member and their guests) notices requiring customers to leave the premises and the area quietly. (Note, this may also include a reference to vehicles).

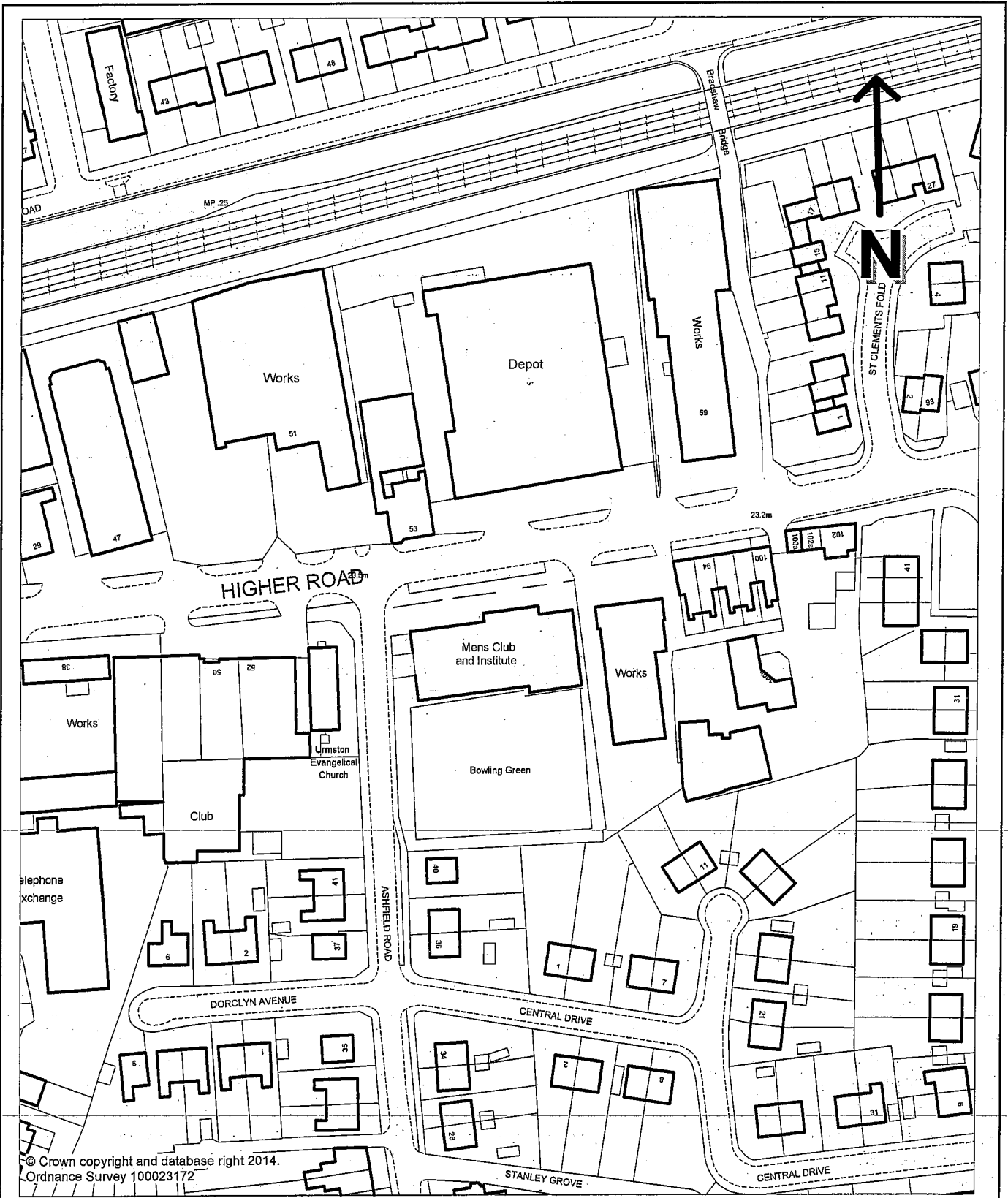

© Crown copyright and database right 2014.
 Ordnance Survey 100023172

TRAFFORD COUNCIL

URMSTON MENS CLUB
82 HIGHER ROAD
URMSTON

Scale 1/1250

Date May 15

File No.

Drawn KI

Area (or thereabouts):

